

FLOOR PLANS CAPACITY CHARTS

THE WESTIN
ALEXANDRIA



MEETING SPACE OVERVIEW

400 Courthouse Square
Alexandria, Virginia 22314-5700
T 703.253.8600 F 703.253.8605
E westinalalexandria@starwoodhotels.com
westinalalexandria.com

THE WESTIN
ALEXANDRIA

SECOND FLOOR

1. EDISON BALLROOM
2. WRIGHT
3. BANNEKER
4. WHITNEY
5. CARVER
6. BELL
7. CURIE
8. HOPKINS BOARDROOM
9. HOPKINS BOARDROOM
PRIVATE FOYER
10. PREFUNCTION

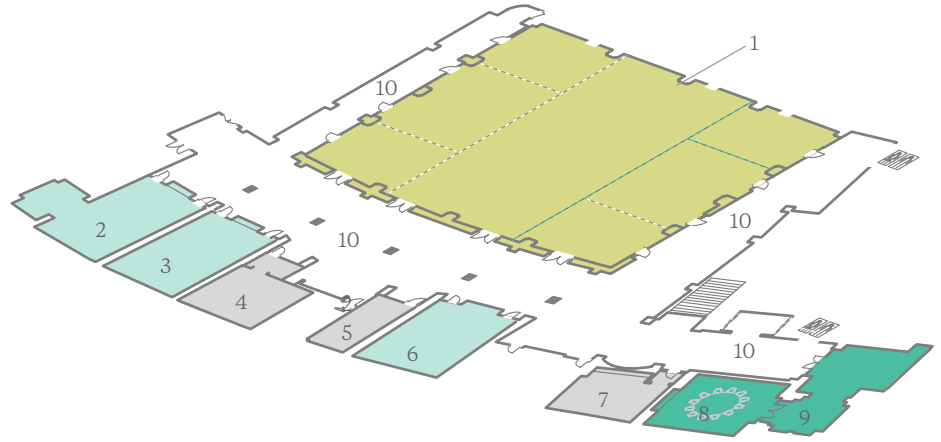

LOBBY LEVEL

1. LOBBY
2. TANGENT
3. TRADEMARK

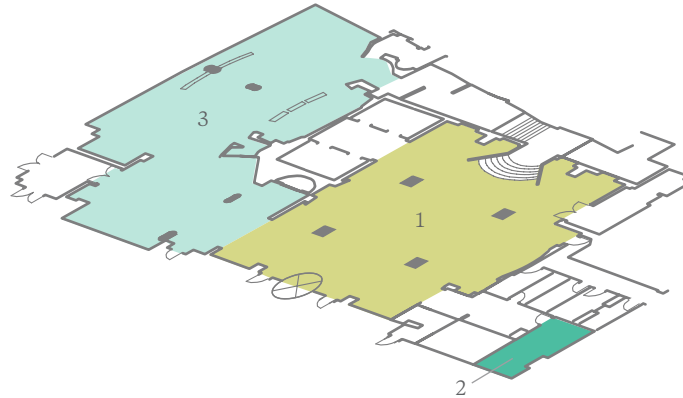

ROOMS AT A GLANCE

| | |
|-------------------------------|--|
| TOTAL GUEST ROOMS | 319 |
| TOTAL MEETING ROOMS | 14 |
| LARGEST MEETING ROOM CAPACITY | 700 |
| LARGEST MEETING ROOM SIZE | 734 m ² / 7,901 ft ² |

Additional spaces for meetings and events, not displayed here, may also be available. Contact your hotel representative for more information.

MEETING SPACE SECOND FLOOR

400 Courthouse Square
Alexandria, Virginia 22314-5700
T 703.253.8600 F 703.253.8605
E westinalexandria@starwoodhotels.com
westinalexandria.com

THE WESTIN
ALEXANDRIA

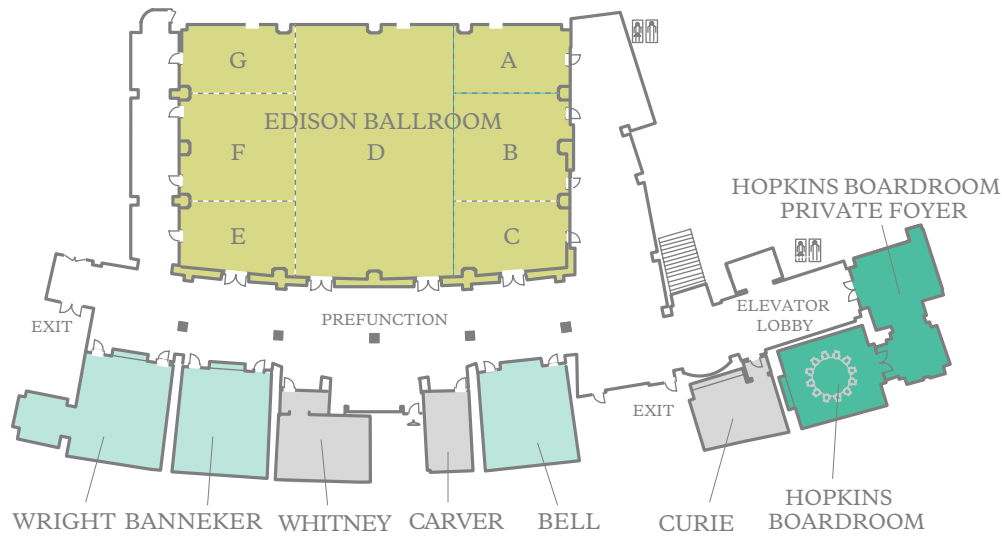

| | DIMENSIONS | AREA (SQ. FT.) | MAX CEILING HEIGHT | THEATER | CLASSROOM | BANQUET | CONFERENCE | U-SHAPE | HOLLOW SQ. | RECEPTION |
|-----------------------------------|-------------|----------------|--------------------|---------|-----------|---------|------------|---------|------------|-----------|
| ■ BANNEKER | 32' X 27' | 848 | 12.1' | 70 | 42 | 60 | 24 | 24 | 32 | 118 |
| ■ BELL | 30' X 27' | 771 | 12.1' | 65 | 30 | 60 | 24 | 24 | 32 | 110 |
| ■ CARVER | 23' X 14' | 320 | 12.1' | 16 | 6 | 12 | 14 | — | — | 44 |
| ■ CURIE | 23' X 25' | 417 | 12.1' | 30 | 15 | 24 | 14 | — | — | 49 |
| ■ EDISON BALLROOM | 73' X 111' | 7,901 | 16.8' | 700 | 420 | 660 | 106 | 114 | 138 | 1,139 |
| ■ EDISON A | 20' X 33' | 637 | 16.8' | 45 | 30 | 36 | 22 | 22 | 27 | 94 |
| ■ EDISON AB | 51' X 33' | 1,636 | 16.8' | 140 | 66 | 108 | 38 | 42 | 50 | 240 |
| ■ EDISON ABC | 73' X 33' | 2,294 | 16.8' | 200 | 108 | 180 | 58 | 62 | 70 | 350 |
| ■ EDISON ABCD | 73' X 78' | 5,607 | 16.8' | 500 | 270 | 384 | 76 | 81 | 108 | 811 |
| ■ EDISON B | 31' X 33' | 999 | 16.8' | 70 | 42 | 72 | 26 | 32 | 40 | 146 |
| ■ EDISON BC | 53' X 33' | 1,657 | 16.8' | 140 | 66 | 108 | 38 | 42 | 50 | 256 |
| ■ EDISON C | 22' X 33' | 658 | 16.8' | 45 | 27 | 36 | 22 | 22 | 27 | 110 |
| ■ EDISON D | 73' X 45' | 3,313 | 16.8' | 300 | 165 | 240 | 58 | 65 | 76 | 461 |
| ■ EDISON DEFG | 73' X 78' | 5,607 | 16.8' | 500 | 270 | 384 | 76 | 81 | 108 | 800 |
| ■ EDISON E | 22' X 33' | 658 | 16.8' | 45 | 27 | 36 | 22 | 22 | 27 | 94 |
| ■ EDISON EF | 53' X 33' | 1,657 | 16.8' | 140 | 66 | 108 | 38 | 42 | 50 | 256 |
| ■ EDISON EFG | 73' X 33' | 2,294 | 16.8' | 200 | 108 | 180 | 58 | 62 | 70 | 350 |
| ■ EDISON F | 31' X 33' | 999 | 16.8' | 70 | 42 | 72 | 26 | 32 | 40 | 146 |
| ■ EDISON FG | 51' X 33' | 1,636 | 16.8' | 140 | 66 | 108 | 38 | 42 | 50 | 240 |
| ■ EDISON G | 20' X 33' | 637 | 16.8' | 45 | 30 | 36 | 22 | 22 | 27 | 94 |
| ■ HOPKINS BOARDROOM | 29' X 24' | 628 | 12.1' | — | — | — | 12 | — | — | 91* |
| ■ HOPKINS BOARDROOM PRIVATE FOYER | 39' X 22' | 858 | 22.9' | — | — | — | — | — | — | 91* |
| ■ PREFUNCTION | 116' X 234' | 8,378 | 12.4' | — | — | — | — | — | — | 900 |
| ■ WHITNEY | 26' X 27' | 619 | 12.1' | 40 | 27 | 36 | 20 | 23 | 28 | 54 |
| ■ WRIGHT | 33' X 44' | 1,037 | 12.1' | 70 | 42 | 72 | 32 | 24 | 32 | 150 |

* COMBINED RECEPTION CAPACITY FOR HOPKINS BOARDROOM AND HOPKINS BOARDROOM PRIVATE FOYER IS 91.

This document contains approximate measurements and square footage that are for illustrative purposes only. We cannot guarantee the floor plan accuracy or completeness, therefore encourage you to review the space to make sure it is suitable for your event.

MEETING SPACE LOBBY LEVEL

400 Courthouse Square
 Alexandria, Virginia 22314-5700
 T 703.253.8600 F 703.253.8605
 E westinalexandria@starwoodhotels.com
westinalexandria.com

THE WESTIN
 ALEXANDRIA

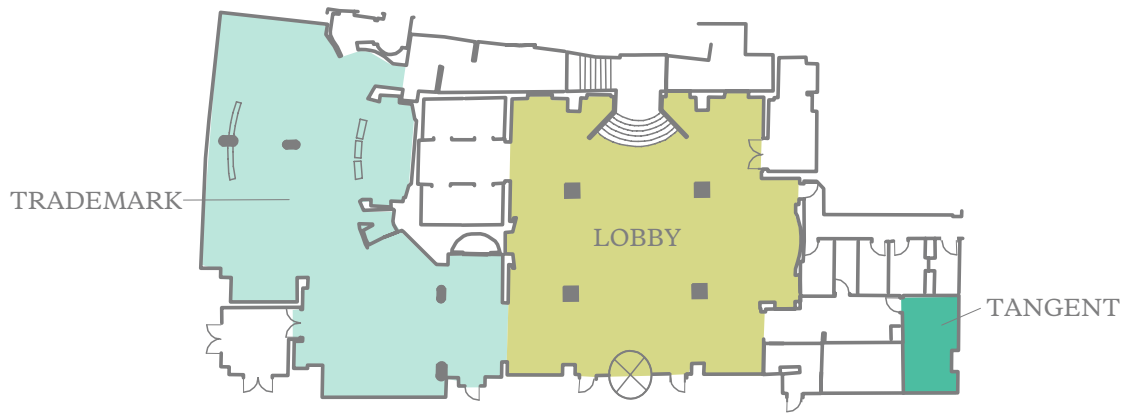

| | DIMENSIONS | AREA (SQ. FT.) | MAX CEILING HEIGHT | THEATER | CLASSROOM | BANQUET | CONFERENCE | U-SHAPE | HOLLOW SQ. | RECEPTION |
|-------------|-------------|----------------|--------------------|---------|-----------|---------|------------|---------|------------|-----------|
| ■ LOBBY | 55' X 50' | 2,750 | 25' | — | — | — | — | — | — | — |
| ■ TANGENT | 22' X 11.5' | 216 | 15.6' | — | — | — | — | — | — | — |
| ■ TRADEMARK | 71' X 35' | 2,575 | 15.6' | — | — | — | — | — | — | 250 |

This document contains approximate measurements and square footage that are for illustrative purposes only. We cannot guarantee the floor plan accuracy or completeness, therefore encourage you to review the space to make sure it is suitable for your event.



400 Courthouse Square
Alexandria, Virginia 22314-5700
T 703.253.8600 F 703.253.8605
E westinalexandria@starwoodhotels.com
westinalexandria.com

THE WESTIN
ALEXANDRIA